

TS-52-52
D-52-52
DE-52-52

- △ REQUIRES ITEM 4
- △ REQUIRES ITEM 6
- △ REQUIRES ITEM 8

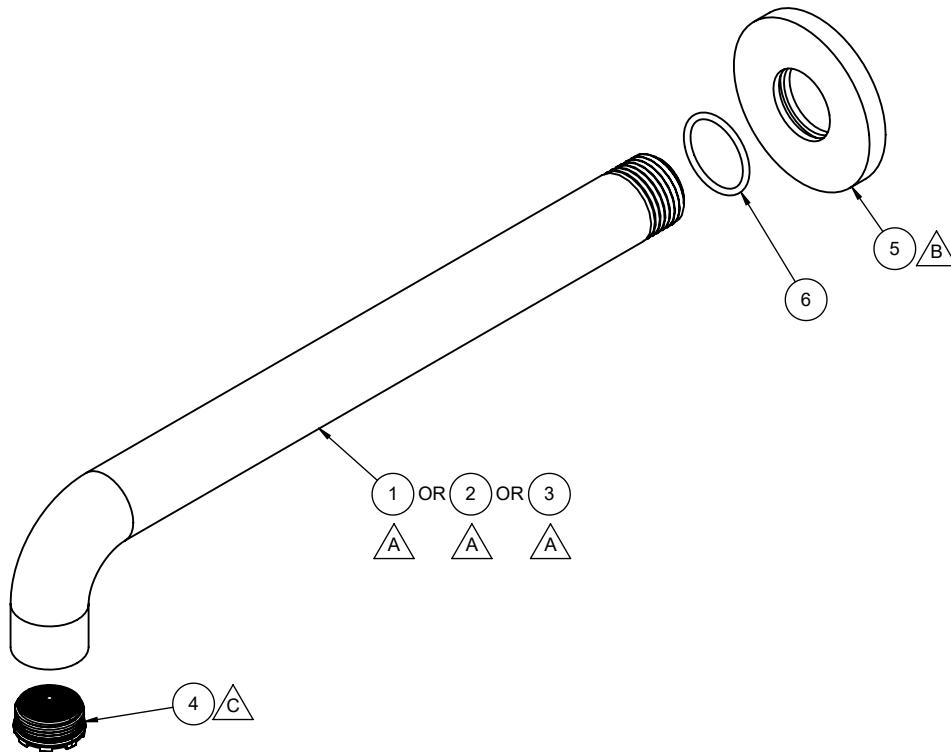

To order spare parts add and/or replace as stated below:

SPD- prefix added to part number(s)
-ZZ replaced with finish code (see finish table)
-WW replaced with **-90** (light finish) or **-96** (dark finish)

Ex: **SPD-7-100463-PC** or **SPD-86030-96**

	ITEM	PART NO.	DESCRIPTION	QTY
for TS-52-52	1	11014-ZZ	SPOUT, W/ 90° BEND, Ø20.65MM (13/16") X 228.6MM (9") LG	1
for D-52-52	2	11015-ZZ	SPOUT, W/ 90° BEND, Ø20.65MM (13/16") X 279.4MM (11") LG	1
for DE-52-52	3	11085-ZZ	SPOUT, W/ 90° BEND, Ø20.65MM (13/16") X 355.6MM (14") LG	1
	4	880453-81	INSERT, TJ AERATED (CACHE), MAX FLOW, LT GRAY/WHT	1
	5	11087-ZZ	WALL SPT BASE RING, CONT, Ø2"	1
	6	87233-80	O-RING Ø20.35 X 1.78 (-019) NBR A70 (NSF61-12 & WRAS)	1
	8	880079-99	KEY, TJ AERATED CACHE	1